

PLAN NOT TO SCALE

185 Campbell Street, Surry Hills
Crane Lift of Construction Materials
Closure of Denham Street and;
Traffic Control Plan 0084 Modified

All advanced warning signs to be spaced as per RMS Roadwork on Worksite Handbook 1 x Distance = speed.

Legend :

- Worksite
- Road Closure
- Footpath Closure
- Eastbound Campbell Street Traffic
- Westbound Campbell Street Traffic
- Eastbound Bloomfield Street Traffic
- Westbound Bloomfield Street Traffic
- Delineator Devices
- Barricades
- Pedestrian Movement
- Traffic Controllers

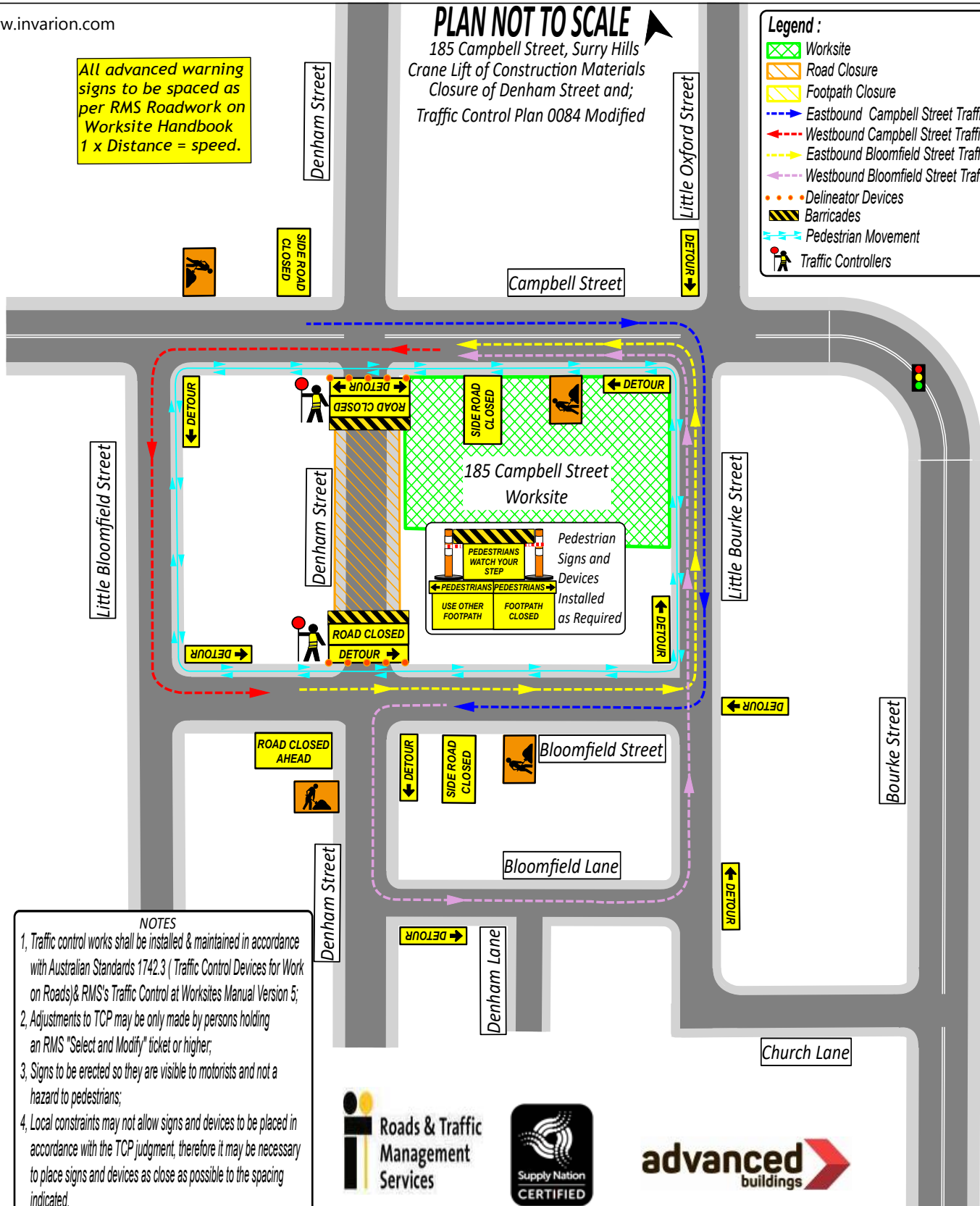

NOTES

1. Traffic control works shall be installed & maintained in accordance with Australian Standards 1742.3 (Traffic Control Devices for Work on Roads) & RMS's Traffic Control at Worksites Manual Version 5;
2. Adjustments to TCP may be only made by persons holding an RMS "Select and Modify" ticket or higher;
3. Signs to be erected so they are visible to motorists and not a hazard to pedestrians;
4. Local constraints may not allow signs and devices to be placed in accordance with the TCP judgment, therefore it may be necessary to place signs and devices as close as possible to the spacing indicated.



Roads & Traffic Management Services (RTMS)
Evan Ng lam
Operations Manager
17 Garner Place
Ingelburn NSW 2565
Ph: (02) 9426 3407
Mob: 0410 431 114
E: rtms.traffic@gmail.com
Lic: 0052055562
Expiry Date: 24/06/2022
Author: Evan Ng lam

Date: 07/05/2020 **Author:** Evan Ng lam **Project:** 185 Campbell Street, Surry Hills. Road Closures for Crane & EWP Works

Comments: PLAN NOT TO SCALE
Proposed rectification and repair works to 185 Campbell Street, Surry Hill worksite requires the closure of Denham St between Campbell St and Bloomfield St for standing crane to lift construction materials to/from the site and standing Elevated Work Platforms (EWP's) to undertake works. Traffic controllers to implement Detour signage and redirect pedestrians around the work area as required. RMS Certified Traffic Controllers will implement and monitor this Traffic Control Plan.
TCP 0084 Modified
(1) Traffic Controllers to manage traffic and pedestrian movement.
(2) Traffic Controllers to be vigilance of surroundings of traffic & pedestrian movements during this activity.
(3) Traffic Controllers to communicate via radio where required.